



Electrolux
PROFESSIONAL

**Warewashing
Medium hot air blower zone without
door for single rinse Rack Type
dishwasher, 220-240V/60Hz**

ITEM # _____

MODEL # _____

NAME # _____

SIS # _____

AIA # _____

888002 (NMSRE3)

Medium hot air blower
without door for single rinse
Rack Type Dishwasher,
electric,570mm,
4.5kW,220-240V/ 60Hz/3
(APAC & LA)

Short Form Specification

Item No. _____

Unit to be medium hot air blower without door suitable to be installed with single rinse rack type dishwasher. Electrical characteristics to be _ 220-240V three phase, 60Hz operation. The addition of the external air reduces the internal humidity thus increasing the drying efficiency without high energy consumption. Construction in AISI 304 stainless steel. Suitable for any feeding direction of the dishwasher thanks to easy reversibility on-site. Full pre-arrangement to be connected with single rinse rack type dishwasher without any modification.

Main Features

- Electronically controlled to optimize drying results.
- All main components made in heavy duty anti-corrosive 304 type stainless steel: internal chamber, external, front and side panels and rack transportation system.
- Drying zone removes most of water from the crockery through a high powered fan that extracts dry air from outside mixing it with the internal air, thus providing dry plates at a temperature cool enough to handle safely.
- The feeding direction can be either left to right or right to left as it's reversible on site.
- Unit to be placed between single rinse rack type dishwasher and handling system.

Construction

- IPx4 water protection.

Sustainability



- The unit is built on modularity concept to easily connect with single-rinse rack type dishwasher without any modification including power connection.

APPROVAL: _____



Experience the Excellence
www.electroluxprofessional.com

Front

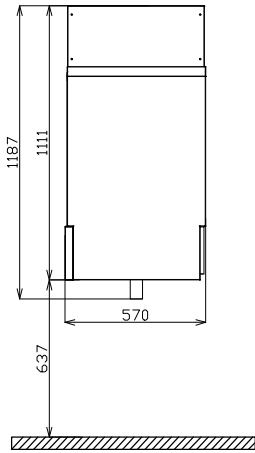

Side

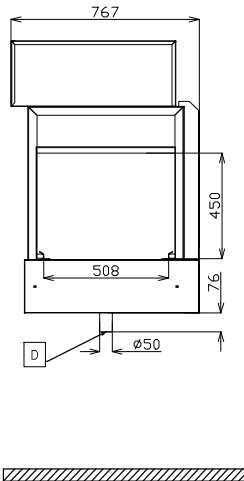

Top

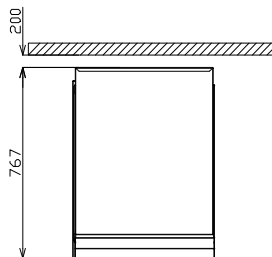

- D = Drain
- EI = Electrical inlet (power)
- EO = Electrical Outlet
- EQ = Equipotential screw
- ES = Electrical signal IN/OUT
- U = USB port

Electric

Supply voltage:	
888002 (NMDSRE3)	220-240 V/3 ph/60 Hz
Default Installed Power:	4.3 kW
Dryer heating elements:	4.13 kW
Drying fan power:	0.17 kW

Key Information:

Dryer air flow:	600 m ³ /h
Dryer air temperature:	50-60 °C
External dimensions, Width:	570 mm
External dimensions, Depth:	767 mm
External dimensions, Height:	1187 mm
Charging hole size (width):	508 mm
Charging hole size (height):	450 mm
Shipping height:	1380 mm
Shipping width:	740 mm
Shipping depth:	920 mm
Shipping volume:	0.94 m ³

Reference norm used to measure the noise: IEC60335-2-58 annex AA.

Sustainability

Noise level:	<62 dBA
---------------------	---------